

U1

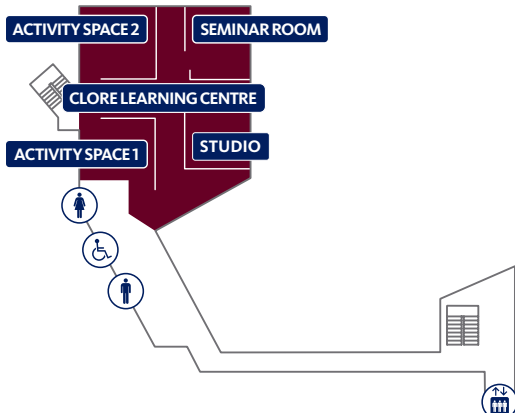

E

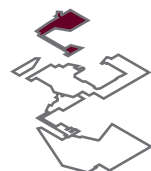
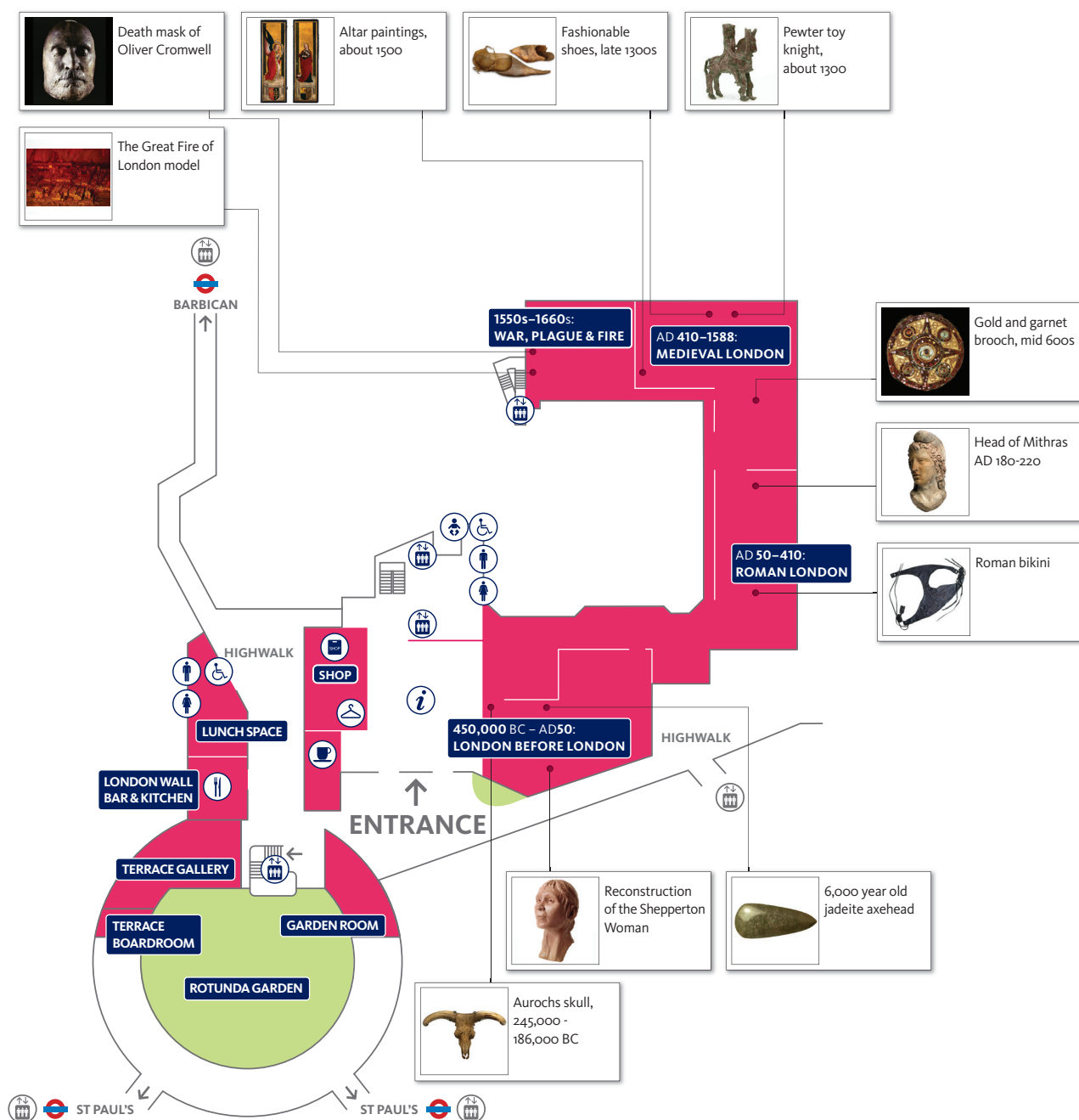

L1

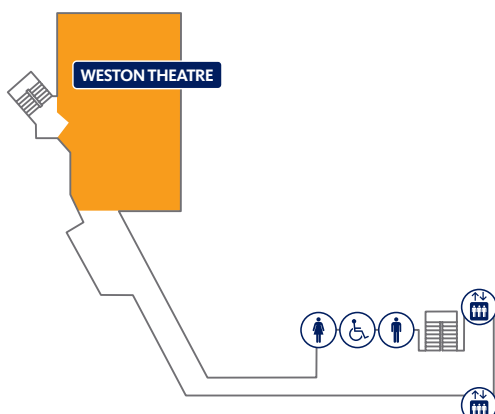

L2

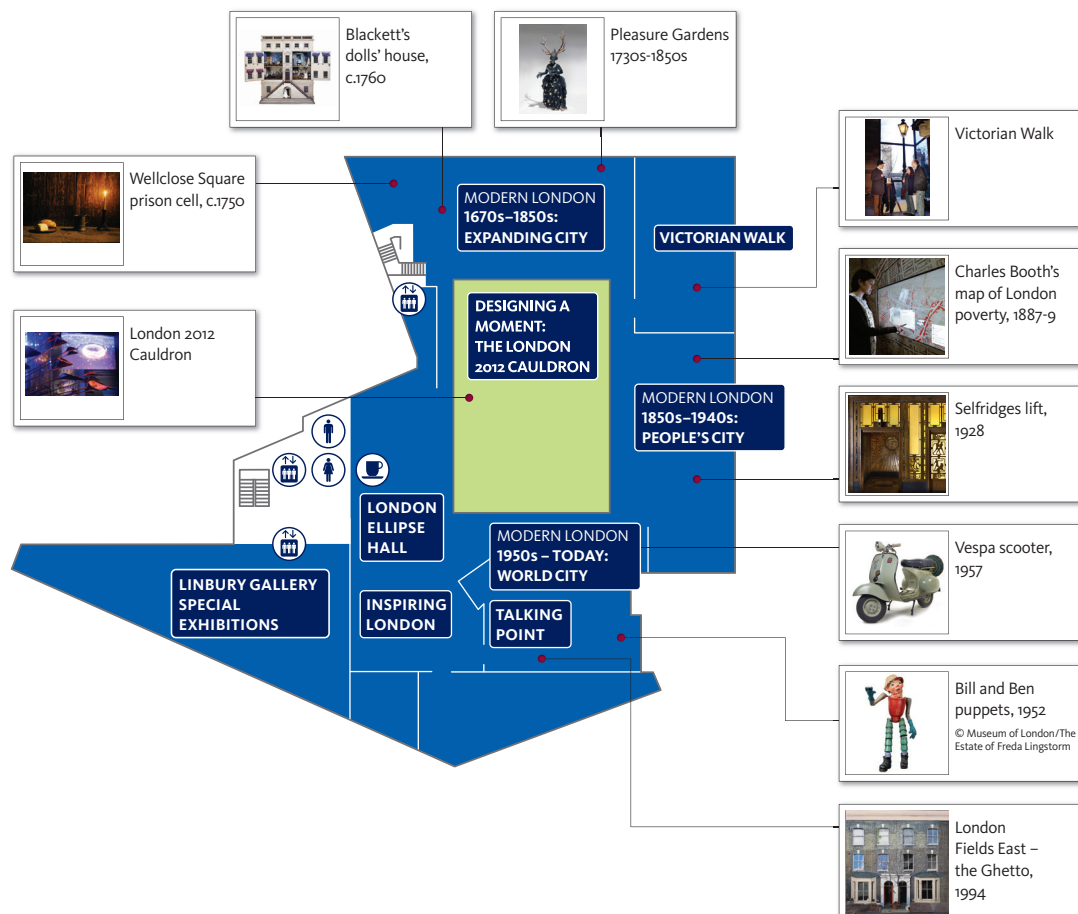

- |                   |                |
|-------------------|----------------|
| MALE TOILETS      | BAR RESTAURANT |
| FEMALE TOILETS    | CAFÉ           |
| ACCESSIBLE TOILET | SHOP           |
| BABY CHANGING     | CLOAKROOM      |
| INFORMATION       | LIFTS          |